

ELEVATION
RM 120 - AUDITORIUM 02
SCALE 1:50

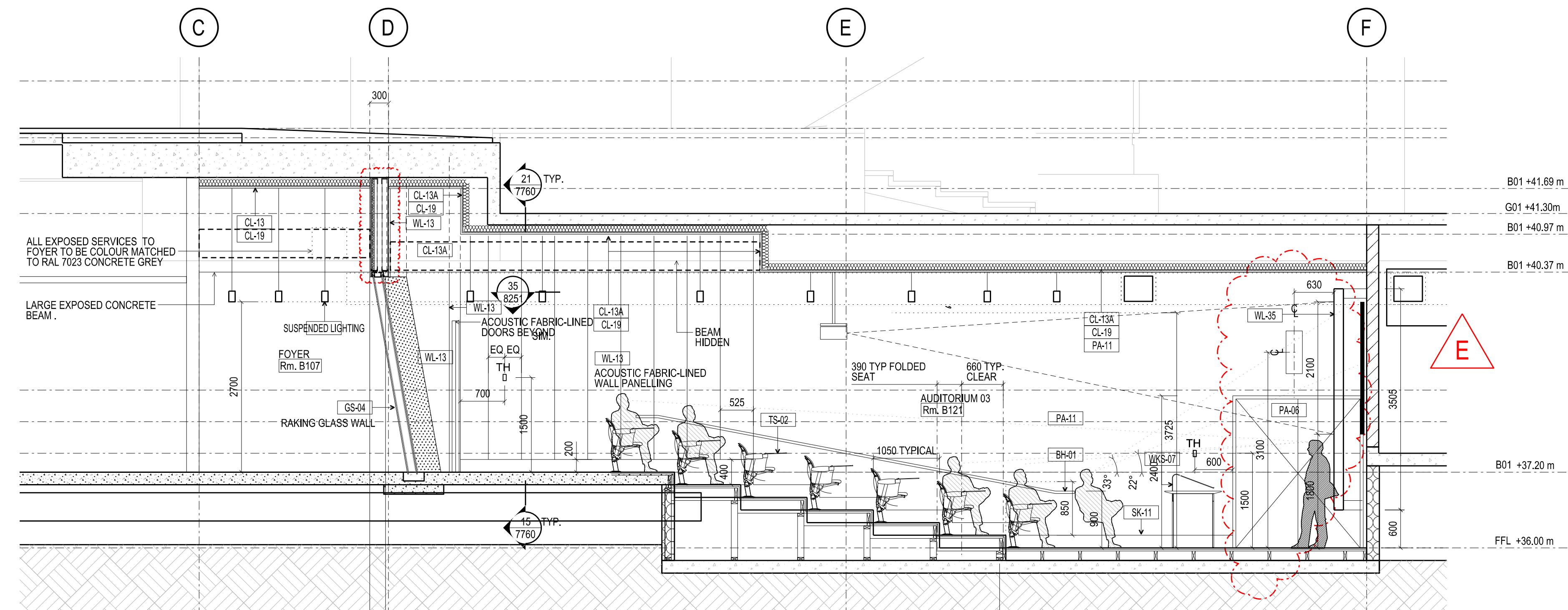

ELEVATION
RM 121 - AUDITORIUM 03
SCALE 1:50

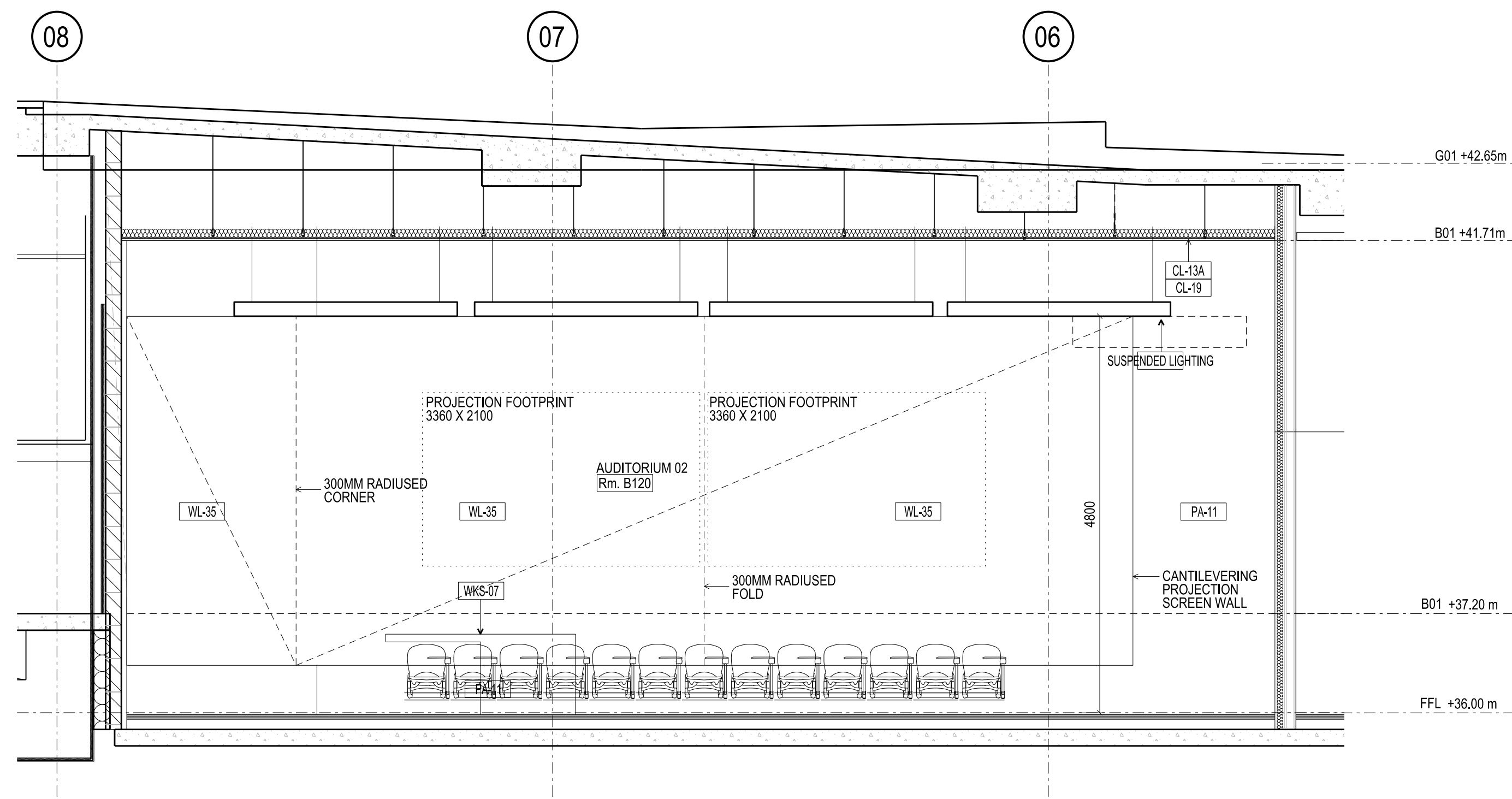

ELEVATION
RM 120 - AUDITORIUM 02
SCALE 1:50

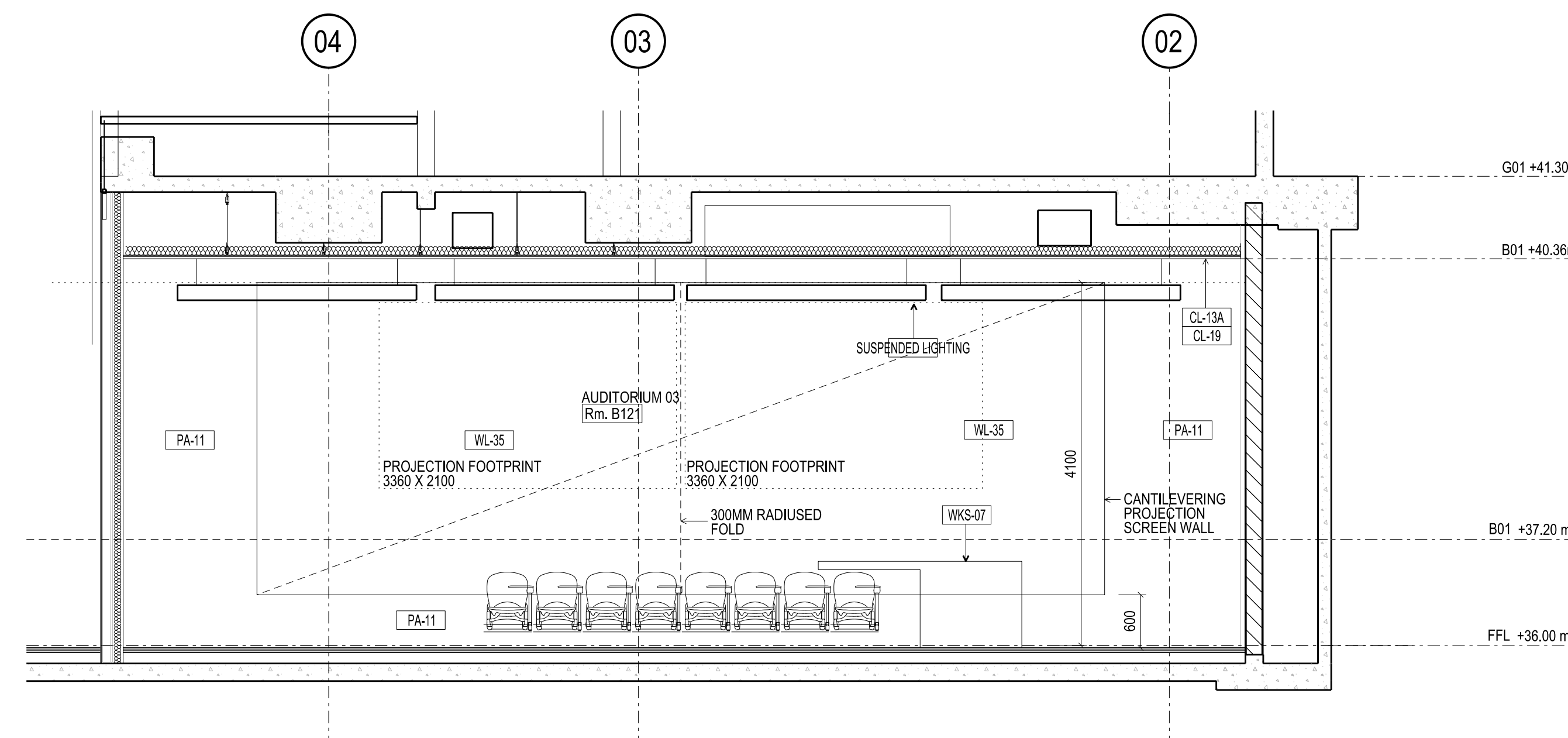

ELEVATION
RM 121 - AUDITORIUM 03
SCALE 1:50

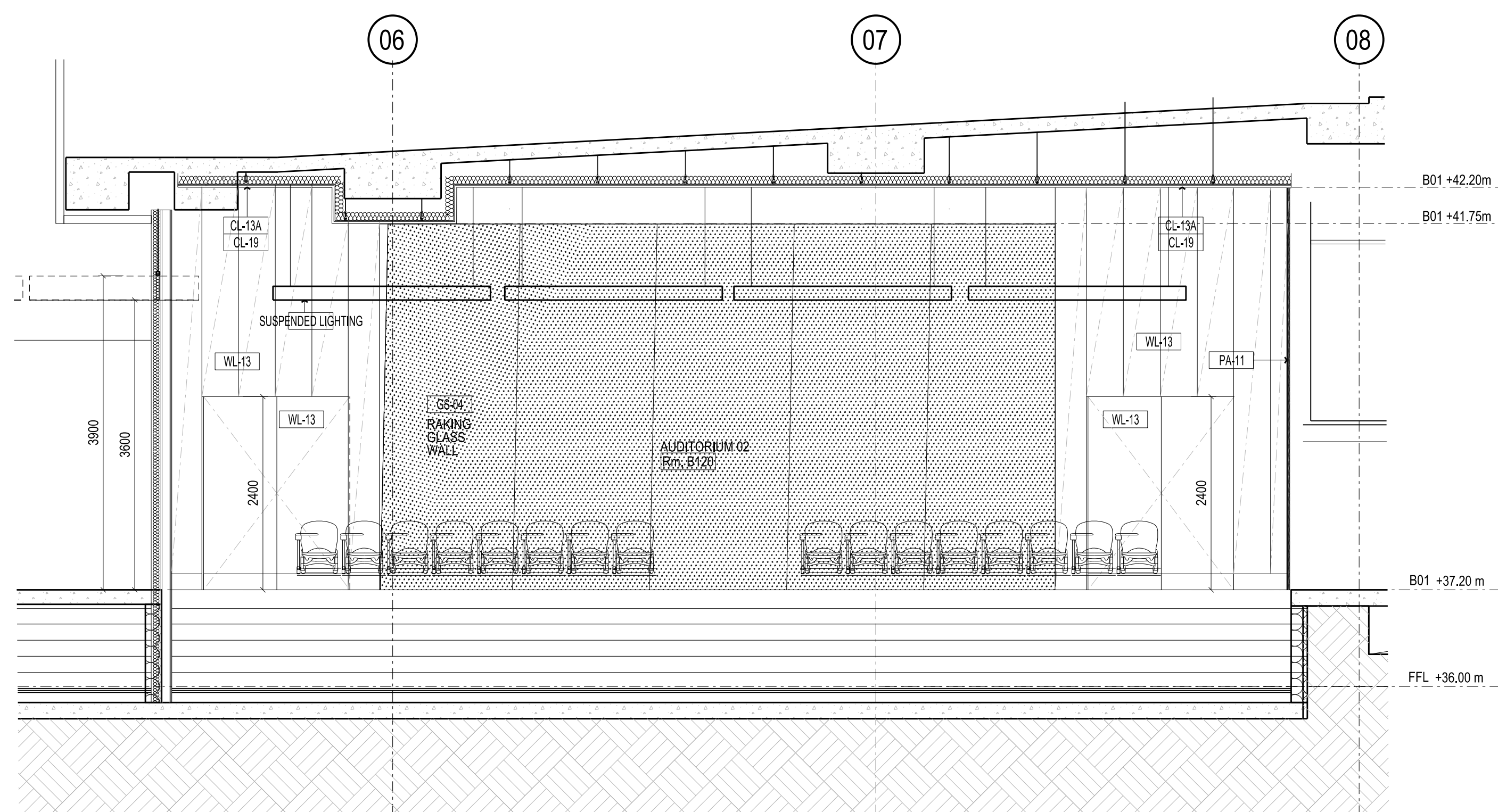

ELEVATION
RM 120 - AUDITORIUM 02
SCALE 1:50

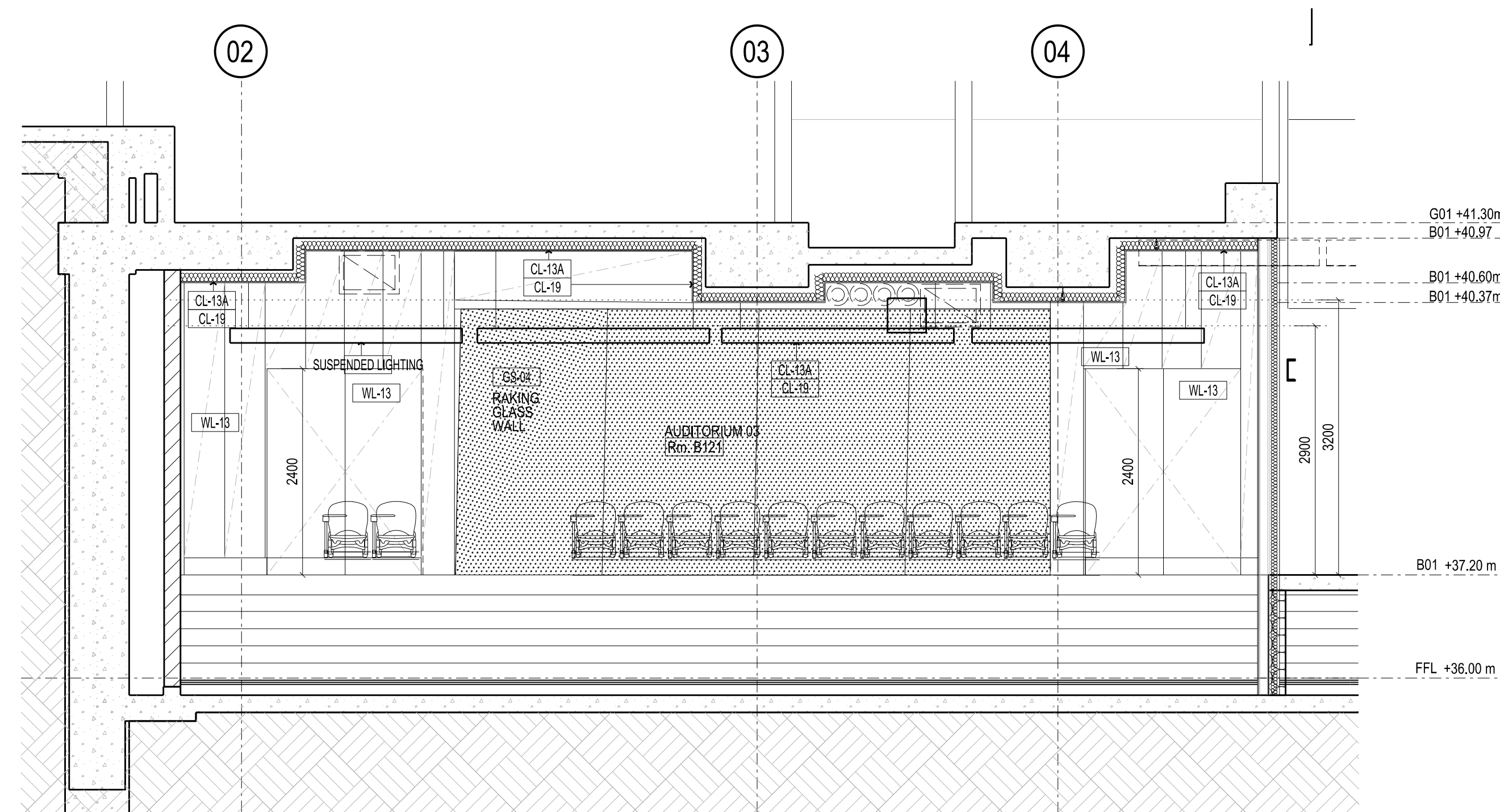

ELEVATION
RM 121 - AUDITORIUM 03
SCALE 1:50

E	SG	RL UPDATES AS CLOUDED	-	12.12.13
D	SG	RL UPDATES AS CLOUDED	-	25.11.13
C	SG	THERMOSTAT LOCATIONS ADDED	-	18.11.13
B	SG	UPDATES AS CLOUDED	-	13.11.13
A	SG	SKIA4 REMOVED	-	30.09.13
04	SG	BUILDING PERMIT ISSUE	-	24.05.13
SEATING ASLE CLEARANCES NOTED				
03	SG	VALUE MANAGEMENT ISSUE	-	28.03.13
02	SG	100% CD - TENDER ISSUE	-	07.09.12
01	SG	95% CD ISSUE	-	10.09.12
Rev	Issue	Revision Description	And	Date



NADAAA
 NADAAA
 1520 Washington Street No.2 Boston Massachusetts 02118 USA
 Telephone +1 617 442 8232
 Facsimile +1 888 442 1417
 Email nadaaa@nadaaa.com

John Wardle Architects
 25 Rokeby Street, Collingwood, Victoria 3066 Australia
 Tel: +61 3 8662 0400 www.johnwardlearchitects.com
 © 2012 John Wardle Architects ABN 83 006 814 268

Client **University of Melbourne Parkville Campus**

Project **Faculty of Architecture Building and Planning**

Title **INTERIOR ELEVATIONS - LEVEL B01 AUDITORIUMS 02 & 03**

Project No.	0913	Scale	1:50 @ A0
Drawing No.	AR5705	Revision	E

Date: May 2011 Drawn: - Co-Ord: - Check: -

FILENAME - SFILES

FOR CONSTRUCTION